

CHILDREN'S TOY CAR OPERATION INSTRUCTIONS

Please read this manual in detail before using



Please read the assembly manual carefully before operating.

Suitable for ages 3-7 years

Always wear helmet when riding

Your new vehicle requires to be assembled by adult only.
Please keep this manual since it contains important information.



WARNING

ASSEMBLY SHOULD BE DONE BY ADULT

1. PRODUCT SPECIFICATION
2. PARTS LIST
3. CAUTIONS FOR SAFETY
4. PARTS DIAGRAM
5. ASSEMBLY STEPS
6. MAINTAINING YOUR VEHICLE

1. Product Specification

Suitable age:	3-7 Years	Battery:	_____
Load Capacity:	25kg	Size of car:	94*63*51 CM
Speed:	3-5km/h	Power way:	_____
Charge:	_____	Average battery life:	_____
Charge time:	_____	Fuse	_____

2. Parts list



Vehicle Body x1



Seatx1



Front Panel X1



Direction Rod X1



Front Bumper x1



The car body stand tube X2
(left and right)



Steering Wheel x1



Panel Sticker x1

Screw Packing



Ø13.7washer x1



Ø 4X10 machine
screwX4



Ø5X35 machine screw x8



Ø5X50 machine screw x 2

3. CAUTIONS FOR SAFETY

1. While riding, adult supervision is required at all times.
Always wear a helmet when riding.
2. Do not drive near roads or on busy walkways and sidewalks.
3. It is not recommended to drive the vehicle on wet surfaces
or on slopes of greater than 15 degrees.
4. It is not recommended to ride this vehicle on sandy
or soft surfaces.
5. Do not use this vehicle outdoors when it is raining .
6. Make sure you come to a complete stop before changing
directions from forward to back.

7. Inspect wires and connections of the vehicle periodically
8. Clean the Go-Kart with dry cloth only.
9. Please follow the correct weight and age limits allowed to drive this vehicle.
10. Adults must teach their children about safe driving procedures.
11. Check the seat to confirm it has been fitted and secured before driving.
12. In order to avoid accidents ,please ensure the vehicle is safe before riding.

Parts Diagram

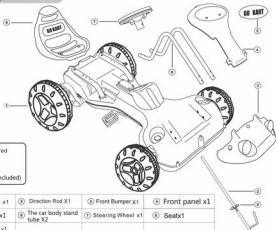

Tools Required



Screwdriver(not included)

① Vehicle Body x1	② Direction Rod X1	③ Front Bumper x1	④ Front panel x1
⑤ Panel sticker x1	⑥ The car body stand tube X2	⑦ Steering Wheel x1	⑧ Seatx1
⑨ @ 13.7washer x1			

Assembly Steps

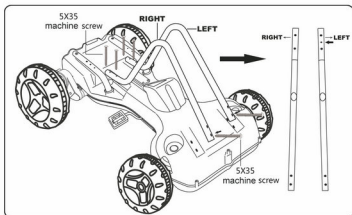

Assemble The car body stand tube

- Secure car body stand tube to car body with 6 screws. /
Notice: Left and Right.

Assemble Direction Rod & Front panel & Panel sticker

- First insert washer on to direction rod, then insert direction rod from under body to car body according to picture, secure front panel to car stand tube. Last, place sticker on front panel.

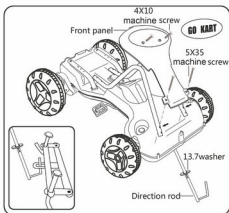

Assembly Steps

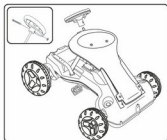

Assembly of steering wheel

- Insert the bolt through the steering wheel and steering column and tighten the screw.

Assembling seat

- Install the seat into car body and tighten the screws.

Note: Seat can be adjusted.

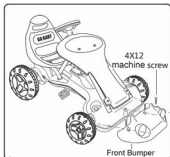

Assembly of front bumper

- As per picture, please take out three 4x12 screws from the car body and insert the front bumper to the car body and tighten the screws.

Maintaining Your Vehicle

- Occasionally use a lightweight oil to lubricate moving parts such as wheels and the steering linkages.
- Park the vehicle indoors or cover it with a tarp to protect it from wet weather.
- Keep the vehicle away from sources of heat, such as stoves and heaters. Plastic parts may melt.
- **DO NOT** wash the vehicle with a hose. **DO NOT** wash the vehicle with soap and water.
- **DO NOT** drive the vehicle in rainy or snowy weather.
- Clean the vehicle with a soft, dry cloth. To restore shine to plastic parts, use a non-wax furniture polish. **DO NOT** use car wax. **DO NOT** use abrasive cleaners.
- **DO NOT** drive the vehicle in loose dirt, sand or fine gravel, which could damage moving parts.



WARNING

To reduce the risk of injury, adult supervision is required. Never use in roadways, near motor vehicles, on or near steep inclines or steps, swimming pools or other bodies of water, always wear shoes, and never allow more than 1 rider.

The toy should be used with caution since skill is required to avoid falls or collisions causing injury to the user or third parties